

Flato Lodge

Ground Level

Guests: 26 Rooms (2 Levels)

Comfortable, private hotel style accommodations; each room sleeps four with two queen-sized beds and private bath. Room #128 is wheelchair accessible.

All linens are provided in rooms. We provide towels for swimming in the river (in the shade shelter between the slide and rope swing) and at the pool (in the shade near the deep end). Please leave your pets at home, as pets are not permitted at Mo-Ranch.

Check In Time: 4:00 pm
Check Out Time: Noon

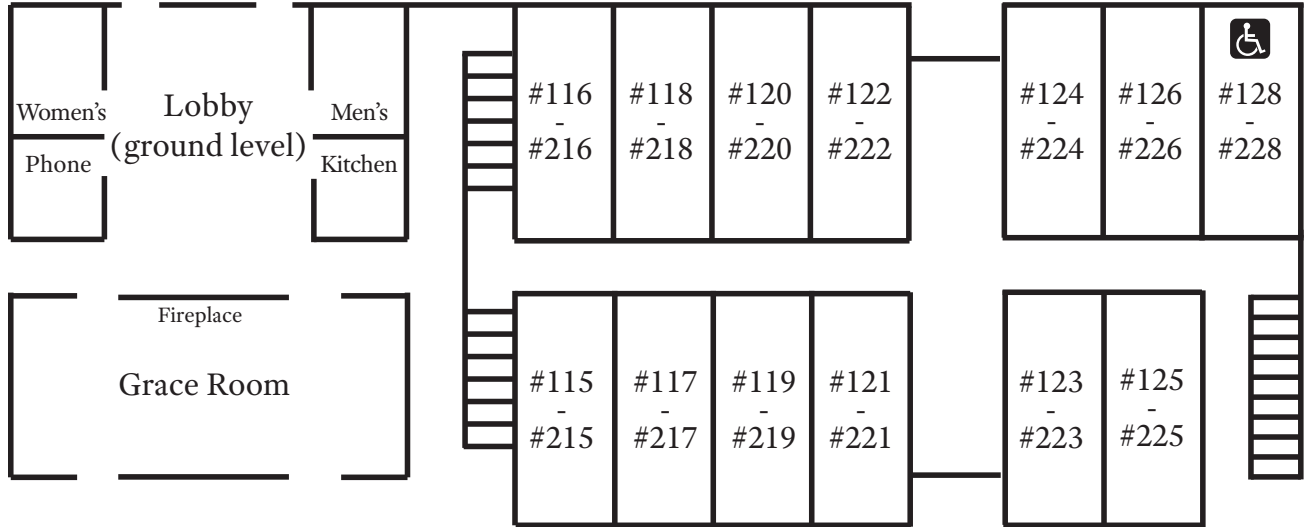
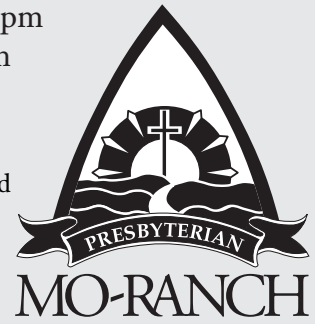

Room #115	Room #116	Room #117	Room #118	Room #119
1.	1.	1.	1.	1.
2.	2.	2.	2.	2.
3.	3.	3.	3.	3.
4.	4.	4.	4.	4.
Room #120	Room #121	Room #122	Room #123	Room #124
1.	1.	1.	1.	1.
2.	2.	2.	2.	2.
3.	3.	3.	3.	3.
4.	4.	4.	4.	4.
Room #125	Room #126	Room #128		
1.	1.	1.		
2.	2.	2.		
3.	3.	3.		
4.	4.	4.		

Flato Lodge

Upper Level

Guests: 26 Rooms (2 Levels)

Comfortable, private hotel style accommodations; each room sleeps four with two queen-sized beds and private bath.

All linens are provided in rooms. We provide towels for swimming in the river (in the shade shelter between the slide and rope swing) and at the pool (in the shade near the deep end). Please leave your pets at home, as pets are not permitted at Mo-Ranch.

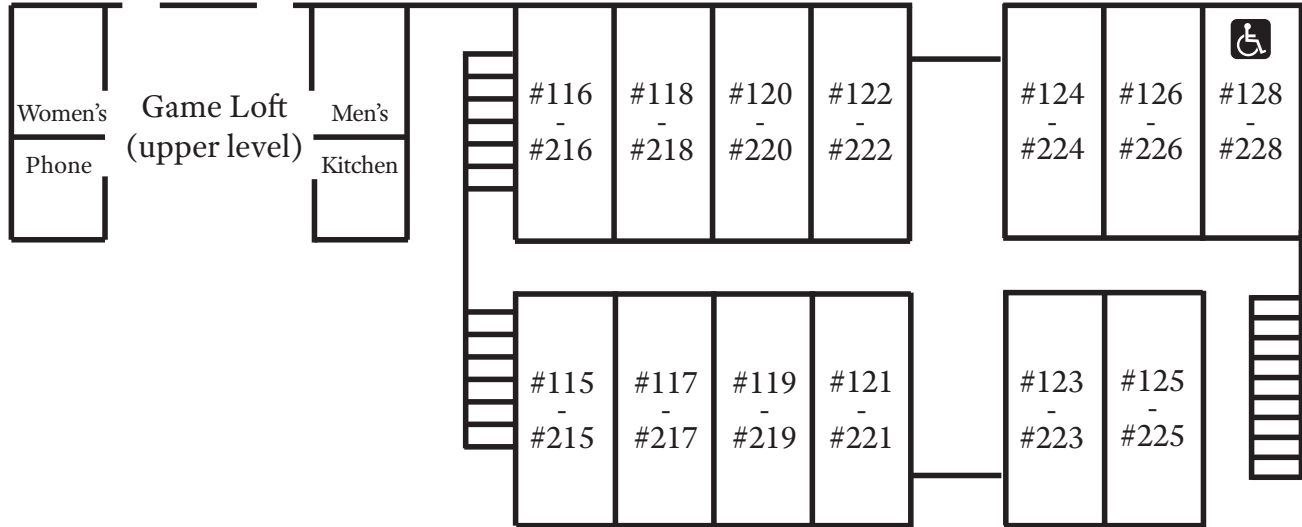

Room #215	Room #216	Room #217	Room #218	Room #219
1.	1.	1.	1.	1.
2.	2.	2.	2.	2.
3.	3.	3.	3.	3.
4.	4.	4.	4.	4.
Room #220	Room #221	Room #222	Room #223	Room #224
1.	1.	1.	1.	1.
2.	2.	2.	2.	2.
3.	3.	3.	3.	3.
4.	4.	4.	4.	4.
Room #225	Room #226	Room #228		
1.	1.	1.		
2.	2.	2.		
3.	3.	3.		
4.	4.	4.		